

[Back to Listings](#)

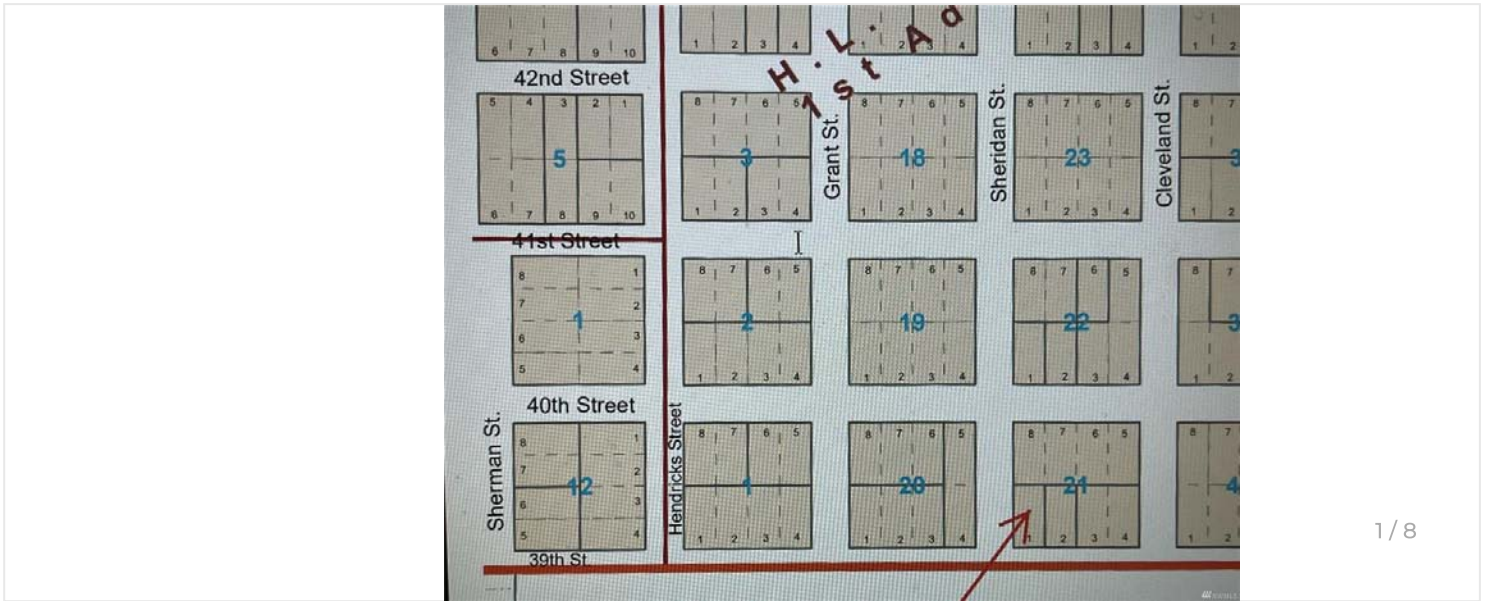

1 / 8



Lot Size Area 4,972.00 sqft



Days on Market: 3

Ready for a hike and own a piece of the Pacific Northwest, here it is! In the area called Capies Trails. Single lot appears to be level and lightly treed with good sun. Parking at 49th and Hendricks on the south side where the public trail starts. Walk 10 blocks and 10 60' street paces you will come to a T. Take a left, all real nice well kept and used trails all up there, go 753 3' steps and look to the left and it "appears" that the lot is ther...



[Read More](#)

Estimated Monthly Cost: \$86 >

Request a Tour

CW

Features

< Prev

All Listings

Next >

Buy / Rent

Favorites

Planner

[← Back to Listings](#)

[Activate Account](#)



Subdivision: North Beach

Property Details ^

Exterior Details

Property Type

Land

Lot Size Area

4,972.00 sqft

Lot Size Dimensions

50x100

Lot Features

Corner Lot, Few Trees, Level

Road Surface

Gravel

Topography

Level

View

Territorial

CW

Buy / Rent

Favorites

Planner

[← Back to Listings](#)

[Activate Account](#)



Sewer

None

Water Source

Not Connected

Utilities

Electricity Not Available, Natural Gas Not Available, Sewer Not Available, Water Not Available

Homeowners Association

Association

No

Other Facts & Features ^

Other Facts & Features

List Price

\$15,500

Directions

See Remarks for directions

Current Use

Residential

CW

Listing Terms

Cash

Zoning Details

Residential

Buy / Rent

Favorites

Planner

[← Back to Listings](#)

[Activate Account](#)



Buyer Agent Compensation*	5
---------------------------	---

*The offer is made only to participants of the MLS where the listing is filed.

Legal & Financial Details

Tax ID	998802101
--------	-----------

Tax Year	2022
----------	------

Annual Taxes	\$126
--------------	-------

Location

County/Parish	Jefferson
---------------	-----------

Subdivision	North Beach
-------------	-------------

MLS Area Major	480 - Port Townsend
----------------	---------------------

Schools

Nearby School Districts

Unified School District

Port Townsend #50

A white circular logo with the letters 'CW' in a dark font, centered on the page.

[Back to Listings](#)



Elementary Schools



Salish Coast Elementary

Public Schools

4.4/10*

Distance: 1.14 miles

Number of students in 2020: 517

Student/teacher ratio in 2020: 15:1

*These ratings, provided by LiveBy, are based on the school's standing compared to other schools in the state. They use the latest available standardized test results (see years specified above) from the Department of Education.

Public Record Data

More information about this property is available from other public sources. Review the information we've found to get a full overview of the property.

[View Public Record Data](#)

CW

[← Back to Listings](#)



No upcoming open houses

How do you feel about this listing?

Disliking won't delete it from your saved searches.

 Favorite

 Not for Me

Talk to your agent Carol Wise about this listing

cw

[Add a Note](#)

[\(360\) 531-1301](tel:(360)531-1301)

carolwise@gmail.com

Getting Around the Neighborhood

Walk

73_{/100}

Most errands can be accomplished on foot

CW

Bike

[← Back to Listings](#)



Transit

40_{/100}

A few nearby public transportation options

Price History

Date: Sep 24, 2015

Event: Sold

Price: \$4,281 **(-7.9%)**

Date: Aug 17, 2005

Event: Sold

Price: \$4,650

Date: Sep 24, 2015

Event: Sold

Price: \$4,281 **(-7.9%)**

